



Profile settings:  
Settings of the current profile  
can be changed here



current profile

Volume of idling and driving.  
The value makes the average of all speakers. For example Aktor 1 = 50% + Aktor 2 = 100% results 75% of the total volume

Main controller volume  
This controller sets the volume for idle and drive in percent.  
This change will NOT be saved in the profile.  
view : „More / adjust volume while driving“



Main View

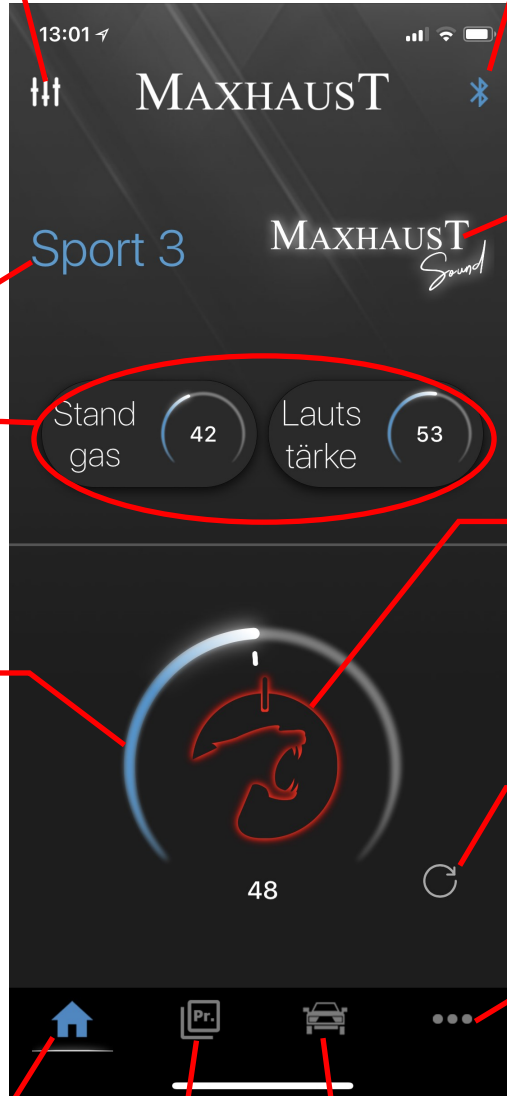

Shows the bluetooth status of the soundbooster.  
blue = connected  
gray = not connected

Shows the current sound selection

System switch on and off



red = System inaktiv

blue = System aktiv

Restore the basic settings of the profile.  
This button only appears when the volume is changed via the main controller

more

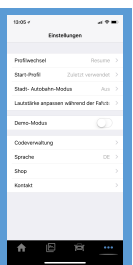

Profile change



Vehicle information





Profiles can be changed in the profile selection (see also „more/profile switching method“).  
Profiles can be added, deleted or postponed.

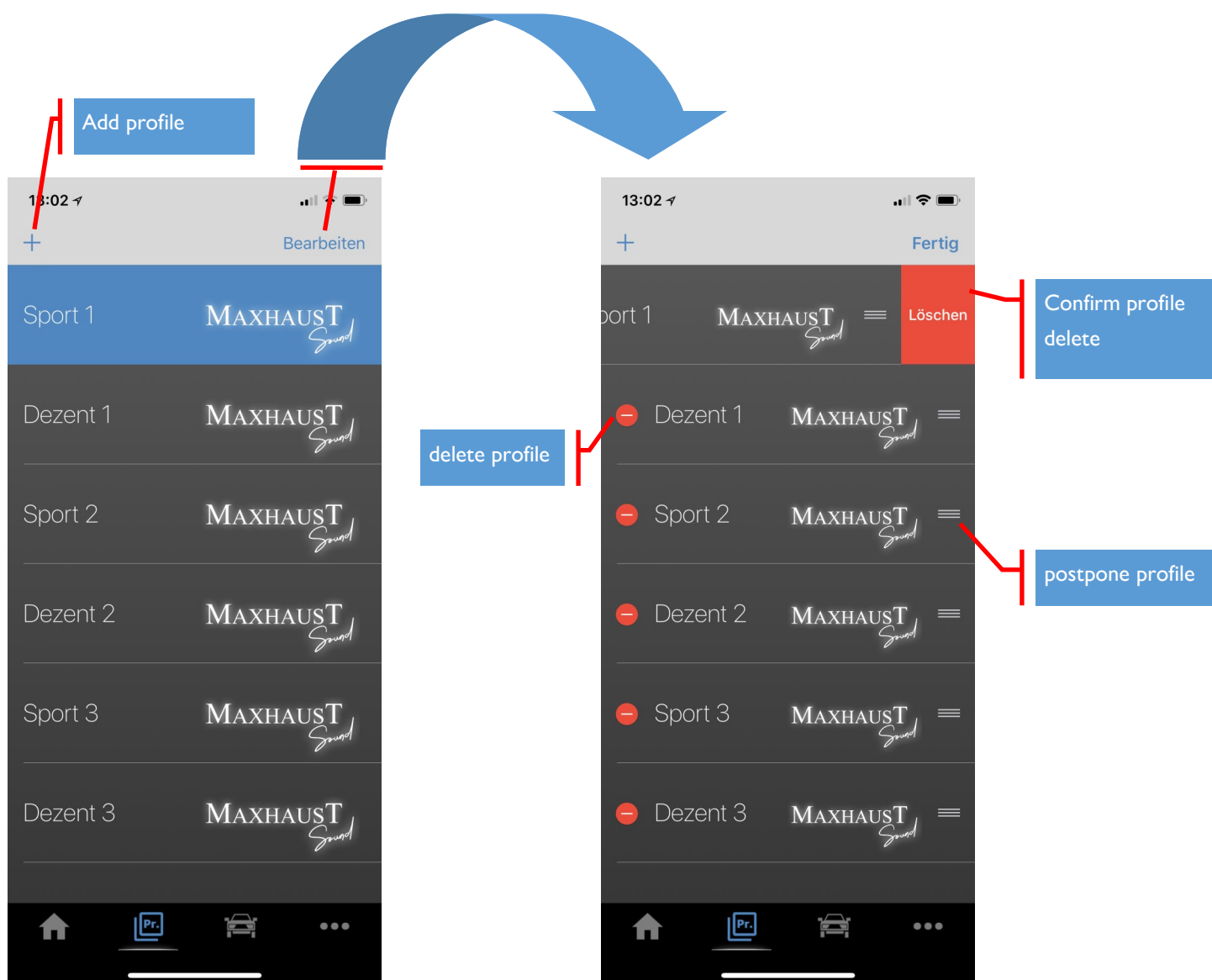

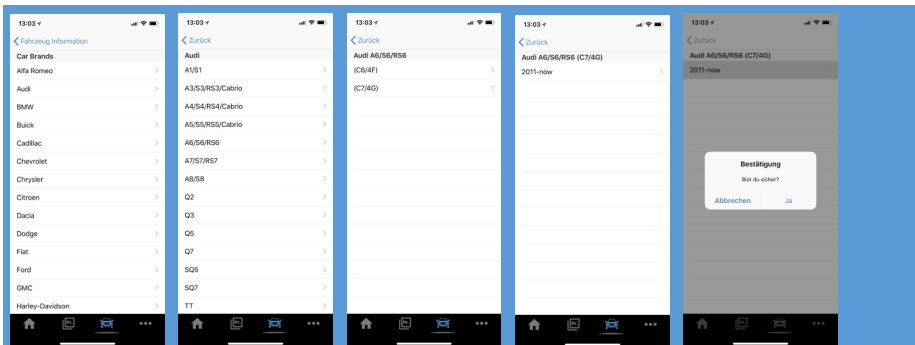
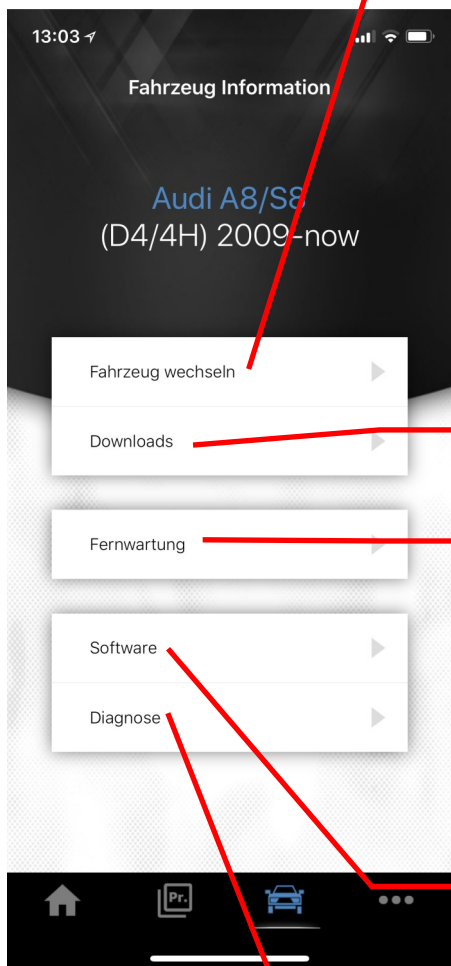

You can install the system in any vehicle and then simply select your new vehicle here in the menu. The software is then transferred via Bluetooth to the sound-booster. Our system is universally usable WITHOUT download restrictions.

Here you will find installation and operating instructions for your vehicle.



In case of problems we can help you via our remote maintenance. We can read the data from your vehicle "live", then update it in our database and make it available for you to download.

If your vehicle does not exist in our database, then we can read out the required data via remote maintenance and provide the software directly.



Under software you get all versions displayed and if necessary you can also update your devices, reset or play new sounds.

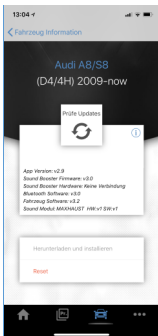

Via the diagnosis you can recognize mistakes quickly. Here you can see all connected actuators and if there is a short circuit. The connection to the vehicle is also checked.



13:05 ↗



## Einstellungen

-  Profilwechsel Resume >
-  Start-Profil Zuletzt verwendet >
-  Stadt- Autobahn-Modus Aus >
-  Lautstärke anpassen während der Fahrt Aus >
-  Demo-Modus
-  Codeverwaltung >
-  Sprache DE >
- Shop >
- Kontakt >



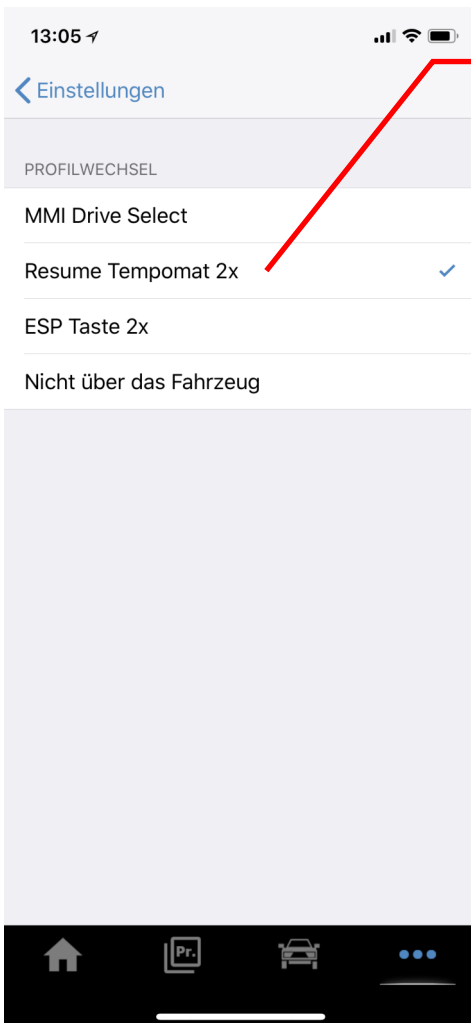

About the setting „PROFIL CHANGING METHOD“ you can set the button to change the profile in the vehicle. We distinguish between the normal profiles and the CAR-profiles.

The „NORMAL“ profiles can be changed via the car buttons, for example cruise control and also via the APP.

At the "CAR" profiles or also driving experience buttons, such as e.g. at Audi the MMI Drive Select, the profiles are specified by the vehicle (Comfort, Auto, Dynamic). A profile change via the app is then not possible.

When selecting "Not via the vehicle", no profiles are changed via the vehicle. Here you can only change the profile via the app.



Example, „CAR“ profile.

AUDI MMI DRIVE SELECT



With which profile the vehicle should start, determine the start profiles.

With selecting "last used", the car always starts in the last used profile.

If you choose profile „CAR“ in the profile change method, e.g.

MMI Drive Select (AUDI), then the car gives the starting profile and this category is not displayed in the app.

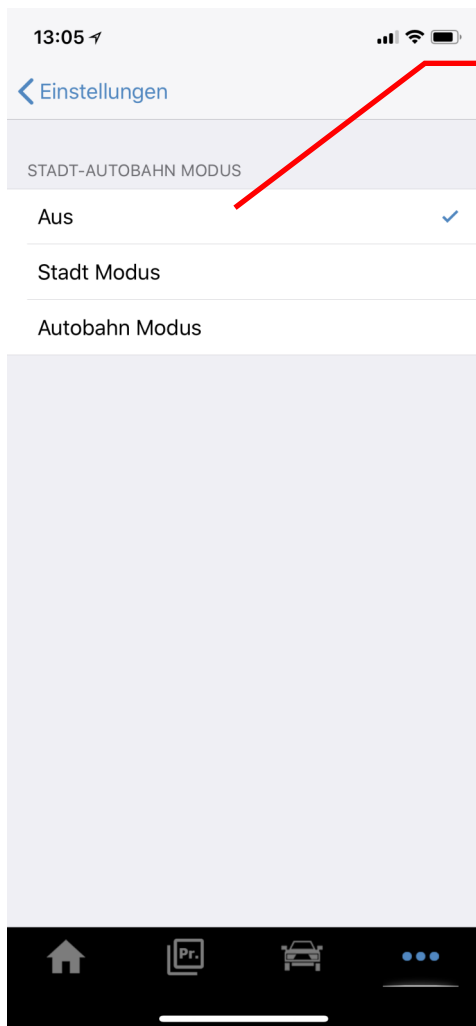

The city-highway mode switches the system OFF and ON again at defined speeds.

### **CITY MODE**

If this is active, the system automatically turns off at 75 rpm and faster and below 50 rpm turns again on.

### **HIGHWAY MODE**

If this is active, the system automatically turns off at 75 rpm and below 75 rpm turns again on.

This feature is not available for all vehicles.

If this is the case with you and you want the function, then call us and we can read then the data of your vehicle via remote maintenance and activate the function.

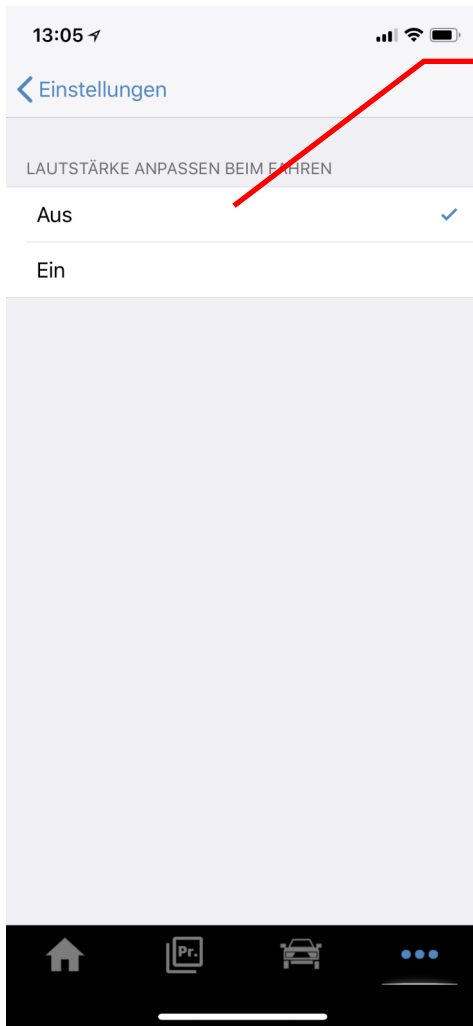

This feature is not available for all vehicles.

If this function is active on you with connected sound booster, then you can activate them and use certain buttons to increase and decrease the volume while driving.

In most cases, you can do this with the cruise control + and -.

The volume is controlled in 10% steps and will NOT saved in the profile.





If the DEMO mode is active, you can operate the system regardless of whether the engine is running

Switching on the ignition is enough and the system runs in idle

A gas will be simulated via the DEMO button

Ideal for demonstrations in the showroom or at fairs where the engine is not allowed to run.



You can deposit a bluetooth password via the code administration.

This is to protect the soundbooster.

If no code is deposited, then anyone can change the settings of your Sound Booster with the app.

Wir recommend to set a password. For that you have to specify your email address. If you forget your password, we can send you the password via email.

Entering the code is only necessary, if you use another mobile or if you delete the or reinstall the app.

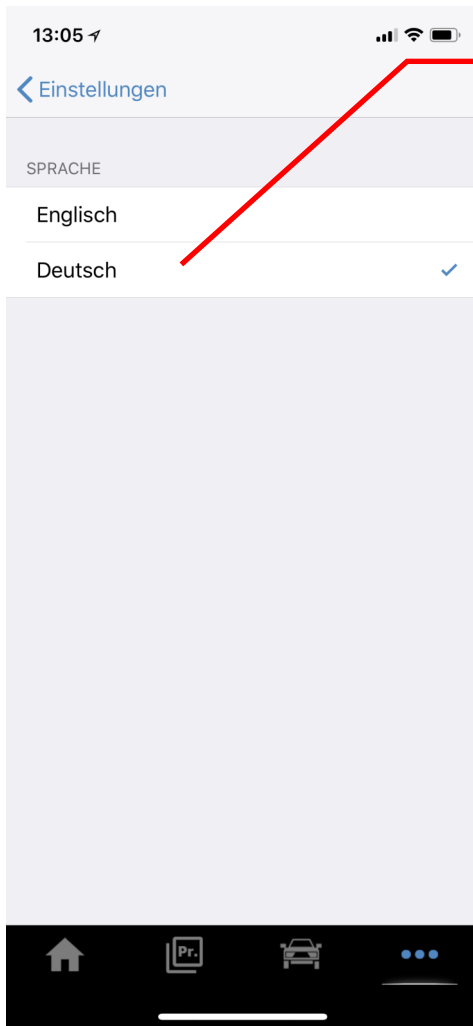

The app automatically adjusts the language of your mobile phone.

If you want to change your language, you can change it here.

Currently available languages are German and English. Other languages are still following.



Closes the profile setting WITHOUT saving.

Rename profile name

Category volume

Category rpm

Saves the current setting

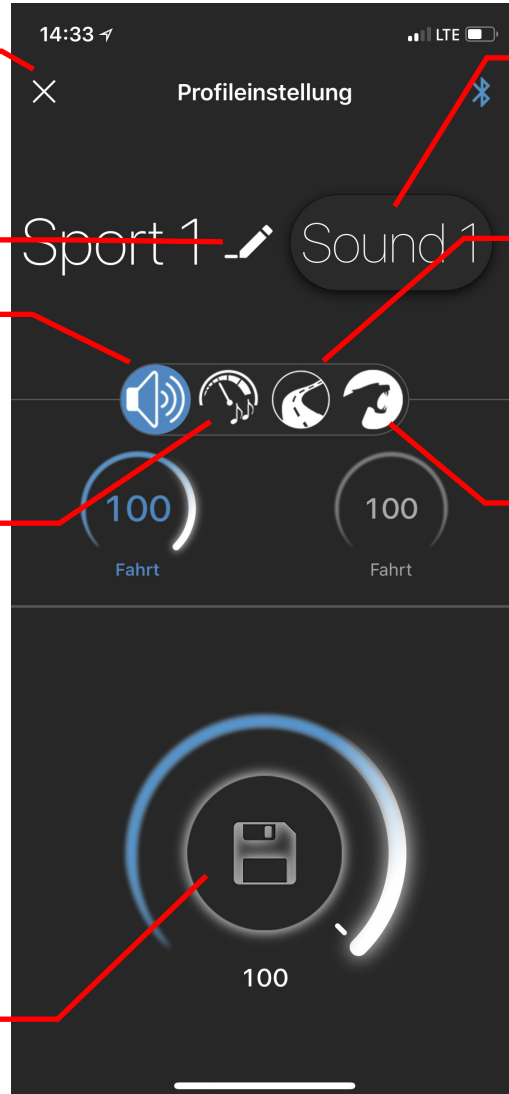

Switches to the menu sound selection

Category street

Category sound-modul



Back to profile setting

13:02



< Profileinstellung

MAXHAUST SOUNDS

Sound 1



Sound 2

Sound 3

Here you can select the existing sounds on the sound module.

If newer sounds are available, then you get this displayed here too and you can update the sounds via "vehicle information / software".



If the Maxhaust Sound module is connected, then all connected actuators are displayed here.

You can adjust each actuator individually in volume.

In this case, 2 actuators are installed and both actuators have a volume of 80% in the idle gas.

With the „slide“ left or right you can change the categories.



actuator 1

actuator 2

Select the actuator you want to adjust and then using the master controller for adjust the volume.

If more than one actuator is installed, then the category "volume" has two slides. The 2nd slide if the for the volume if you give gas. This volume you ONLY hear when you give gas.

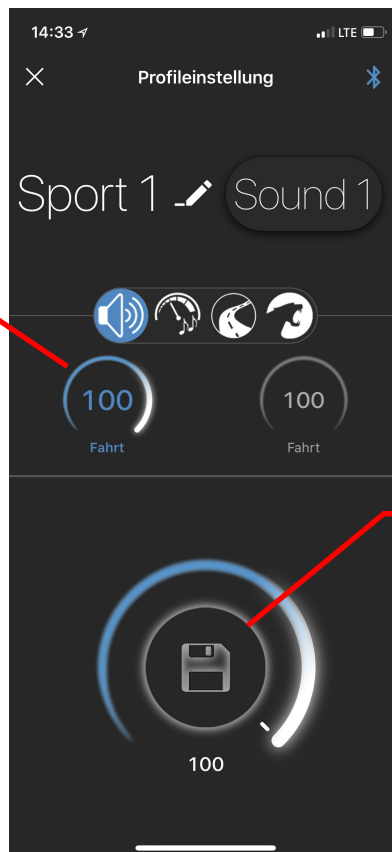

If a change has been detected, the floppy disk will light red to save.. Only after saving, the changes will be taken over in the profile.



changes the audible rpm of the idle, independently of the rpm of the real engine.

The sound setting changes the frequency of the gas. The higher the sound, the higher the rpm. Example: RPM of the vehicle is 2000 rpm. Sound stands on 50. The audible rpm is then at 2500 rpm.

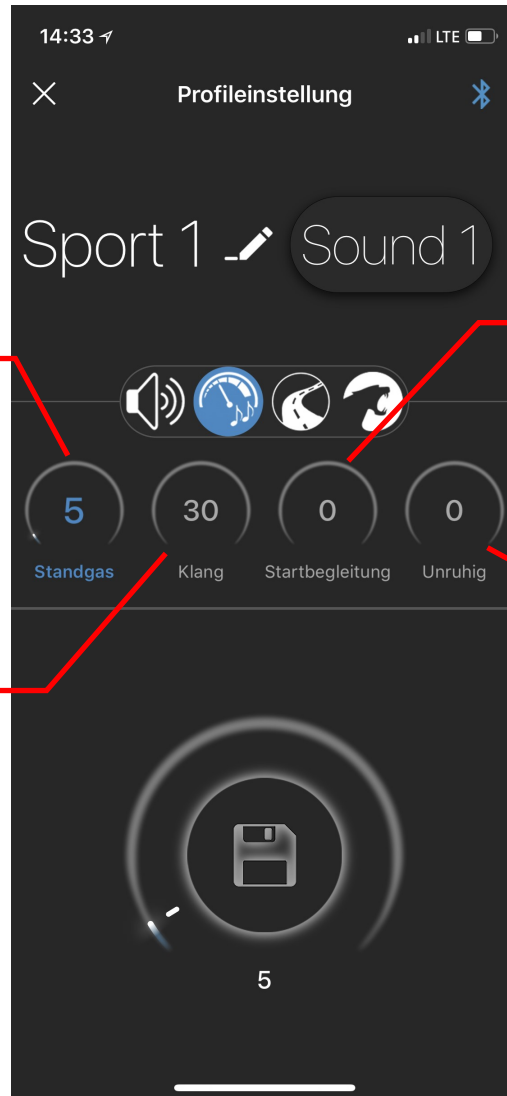

The starting accompaniment generates a howl when the engine is started.. The sports car is usually the case.

The restless run simulated a fluctuation of the RPM in the idle. This makes the sound a bit more realistic in idle.

#### TIP:

If the idle is on a value of 10 and the sound on value of 30, the the rpm of the vehicle is reproduced 1:1



#### RPM-dependent volumes - Adjustment

When you give gas the value regulates the volume to 2500 rpm.

Is the value on 50, then the engine sound starts in the below rpm range with 50% volume and then reached full volume only at 2500 rpm.

If this value is 0, this is deactivated and the volume is identical in all rpm ranges.

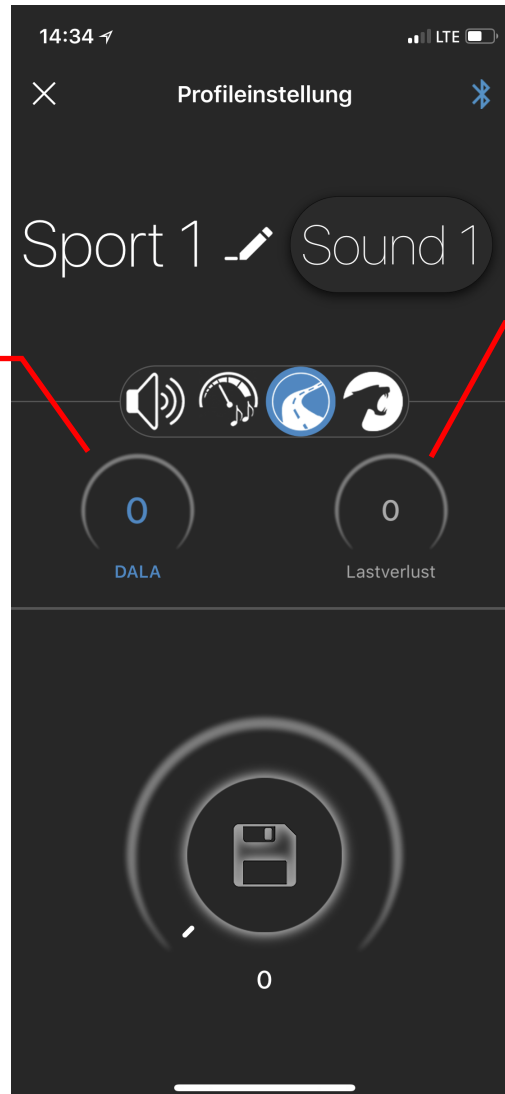

The load loss decreases the volume as soon as no load is applied.

If you give gas the sound seems louder, because the engine produce more load.

If no gas is given, then regulates the volume down.





The bass makes the sound seem deeper.

The heights make the sound brighter.

The intensity makes the sound more intense and aggressive.

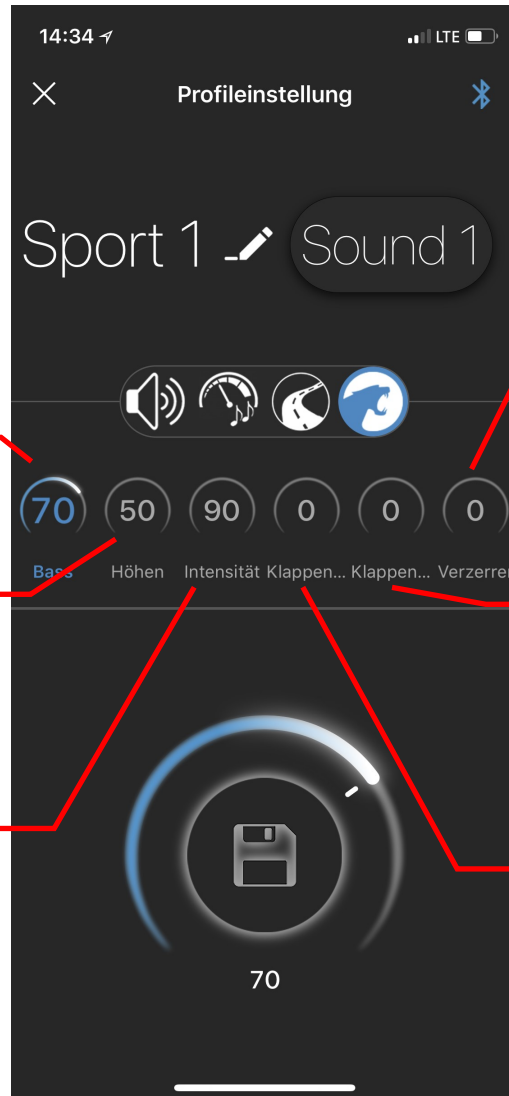

The distortion changes the sound again very much.  
As the name indicates, the sound is more distorted and dirty.

Cutout power regulates how often the backfire sound should come.  
Less or more often.

The cutout START, activates the cutout. It will generate a backfire sound in case of load loss.  
The range is between 1500 and 4000 rpm.